



**GOODS HOIST**

# ADVANTAGES OF HAVING TECH GOODS HOIST





#### **BRAND IMAGE**

Help to build your customer trust



#### **LABOUR**

Reducing of manpower dependency



#### **COST**

Saving on company operating cost



#### **TIME**

Increasing business competitiveness with highly saving on goods transferring time



#### **SPACE**

Workspace is begin fully utilised



#### **Reliability**

A reliable investments which could last for decades



# SPECIFICATION

## GOODS HOIST

**SAFE WORKING  
LOAD (SWL)**

: 2000 kg

**CAR SIZE**

Width	Depth	Height
1220 mm	1220 mm	2130 mm
1530 mm	1530 mm	2440 mm
1830 mm	1830 mm	-
2130 mm	2130 mm	-

**NO. OF STOP**

: 2/3/4/5

**TRAVELLING**

: Up to 12000mm

**CAR WALL MATERIAL**

: Mild Steel Plate

**CAR PLATFORM**

: Mild Steel Chequered Plate

**RIGID GUIDE RAIL**

: Mild Steel I-Beam

**MOTOR ROOM**

: Mild Steel I-Beam with Platform

## LANDING AND CAGE DOOR

**DOOR TYPE**

: Fast Speed Door

**CONTROL MODE**

: Fully Auto

**DOOR MATERIAL**

: Double Layer Aluminium

**DOOR OPENING SPEED**

: 200 mm/sec

**DOOR RAIL**

: Trackless Door System



# ELECTRICAL

<b>SYSTEM</b>	: Smart Control System
<b>CONTROL STATION</b>	: Push Button With Digital Display and Emergency Stop Button
<b>CONTROL VOLTAGE</b>	: DC24V
<b>LED LIGHTING</b>	: 2
<b>CONTROL STATION</b>	: At All Floor

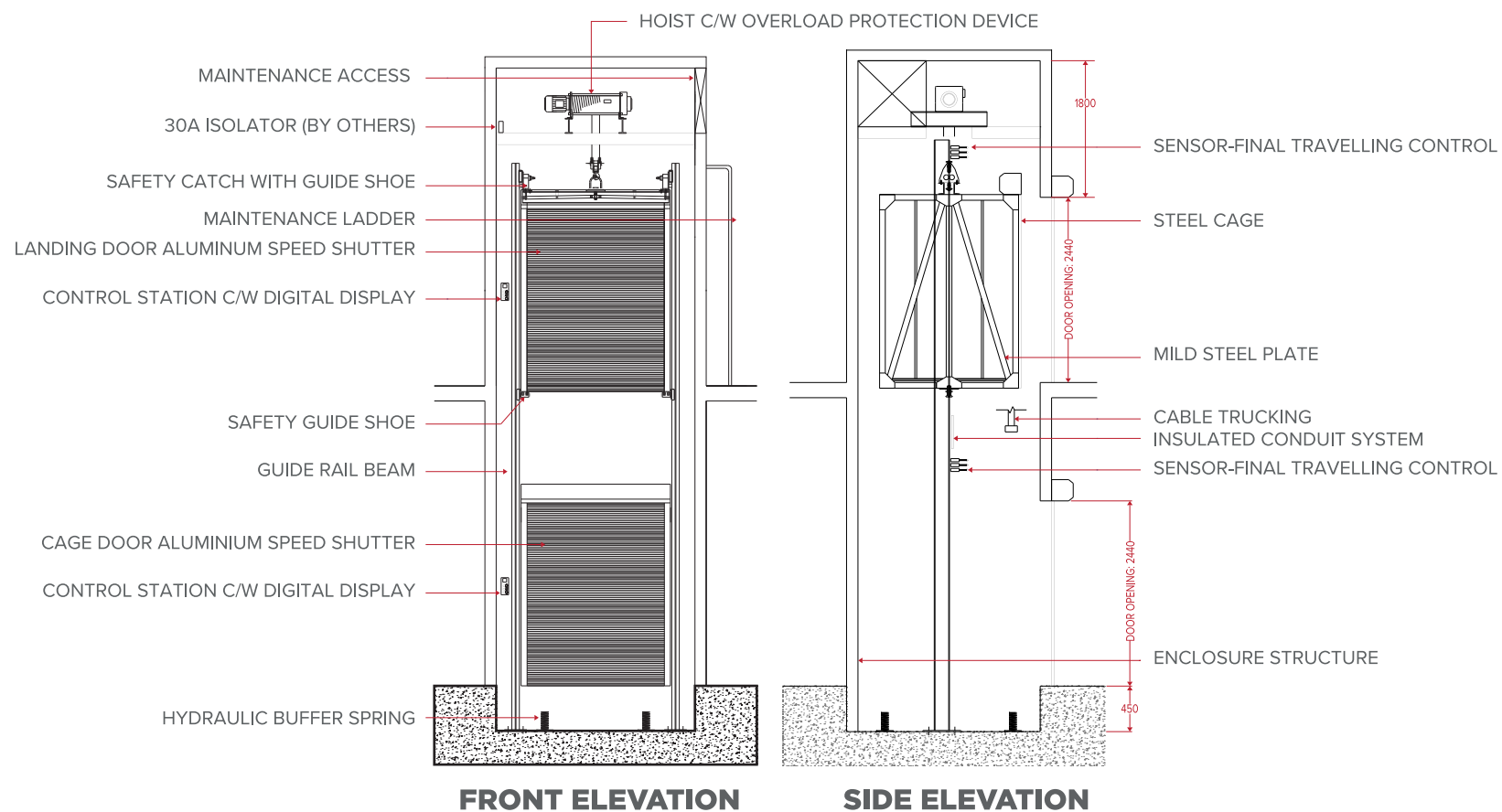

## ADVANTAGES OF OUR HOIST



**HIGH TENSILE WIRE ROPE**



**HOISTING LIMIT SWITCHES**



**WIRE ROPE GUIDE**



**OVERLOAD PROTECTION SYSTEM**

## HOIST SPECIFICATION

<b>HOIST TYPE</b>	: Foot Mounted Electric Wire Rope Hoist
<b>HOIST MODEL</b>	: RVB3.2
<b>HOIST CAPACITY</b>	: 3200kg (3.2 Ton)
<b>LIFTING HEIGHT</b>	: 9 / 12 meter
<b>ROPE REEVING</b>	: 2 / 1
<b>LIFTING SPEED</b>	: 10m / 1.6min
<b>LIFTING MOTOR</b>	: 6.1 / 1.00 Kw
<b>ROPE DIAMETER</b>	: ø10mm
<b>POWER SUPPLY</b>	: 415V 50Hz 3ph

## EUROPEAN STANDARD HOIST



# SAFETY FEATURES

Our Hoist bear the CE mark for compliance with the Machinery Directive 2006/42/EC providing the regulatory basis for health and safety requirements at European Union level.

- ✓ Programmable Logic Controller
- ✓ Overload Protection System
- ✓ Motion Sensor, Curtain Sensor and Magnetic Sensor
- ✓ Hoisting Rope Guide
- ✓ Safety Catch Mechanism
- ✓ Over Travelling Safety Switches
- ✓ Hydraulic Buffer Springs
- ✓ Door Limit Switch
- ✓ Electrical Door Safety Lock













# WHY CHOOSE TECH GOODS HOIST ?

		TECH	OTHERS	ILLEGAL
	<b>HOIST</b> Country Origin Driven Motor Lifting Speed	Heavy Duty European Standard Dual Speed 10 m /1.6min	Taiwan/China Single Speed 6 m/min	Chain Hoist/Winch Single Speed 4 m/min
	<b>DOOR</b> Trackless Landing Door Cage Door Both Door Operating Mode Door Opening Speed	Fast Speed Auto Door Double Layer Aluminium Door Auto Operated 200 mm/sec	Collapsible Gate Collapsible Gate Manual Operated Manual	Hand Rail Without Door Manual Operated Manual
	<b>CONTROL SYSTEM</b> Control System Auto Closing Door	Smart Control Yes	Single Floor Control No	Single Floor Control No
	<b>SAFETY FEATURES</b> PLC Overload Protection Motion Sensor Hoisting Rope Guide Safety Catch Mechanism Door Limit Switches Over Travelling Safety Switches Buffer Spring Door Safety Lock	● ● ● ● ● ● ● ● Electrical	● ● ● ● ● ● ● ● Mechanical	● ● ● ● ● ● ● ● ●
	<b>LICENSING</b> JKKP Approval Insurance Cover	● ●	● ●	● ●

# APPS PROVIDES MAXIMUM CONVENIENCE

- ✓ About us
- ✓ Schedule
- ✓ Services History
- ✓ Equipment Data
- ✓ Call For Breakdown Attendance
- ✓ Real-Time Location On Service Provider
- ✓ Paperless System, Environment Friendly

**6 YEARS WARRANTY**  
*Service Maintenance  
Breakdown Labours*

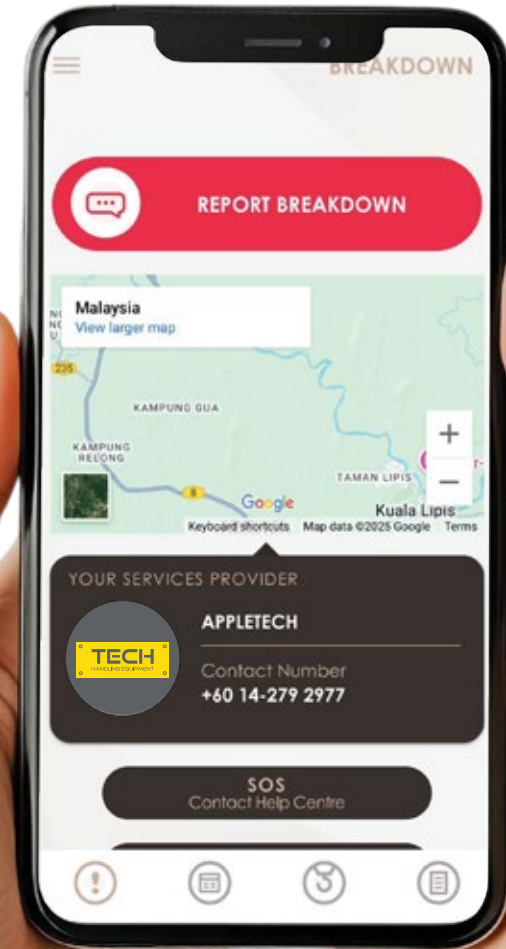

# ALL IN ONE PACKAGE

INCLUDE :

✓ Service Maintenance   ✓ All Parts Ready   ✓ Breakdown Labour   ✓ JKKP Renewal



## 24 HOURS ON-CALL SERVICE



 [info@techequipment.com.my](mailto:info@techequipment.com.my)